

SWISS KRONO sp. z o.o. Serbska 56 68-200 Żary Polska/Poland

Assembly instructions – Stop Fire construction chipboard panels

Transport

Stop Fire fire-retardant chipboard panels and Stop Fire fire-retardant laminated chipboard panels should be transported and stored in a place preventing it from damage and moisture.

Storing pallets in a warehouse

It is best to allocate a closed and well-ventilated storage room with a flat and hardened surface for storing the panels. Before you use a panel on a construction site, the panels need at least a recommended 24-hour period of acclimatisation to the new conditions.

According to the rules for wood-based materials protection and securing, it is recommended that the panel's humidity does not to exceed 15% during the assembly. This level of humidity excludes the possibility of harmful fungi and mould to appearing.

Types of panels

- SWISS KRONO Stop Fire fire-retardant chipboard panel (B-s2,d0,)
- SWISS KRONO Stop Fire fire-retardant laminated chipboard panel (B-s2,d0,)

General purpose panels, type P2 for furnishings (including furniture) for use in dry conditions. Every SWISS KRONO panel has an identification imprint on the edge of the panel; furthermore, the inner layer of Stop Fire panels is coloured red.

Assembly

Stop Fire fire-retardant chipboard panel and Stop Fire fire-retardant laminated chipboard panel can be assembled vertically or horizontally. An expansion joint of min. 3 mm must be unconditionally kept between panels and around holes for doors and windows. Recommended spacing of supports for panels 18 mm thick as walls finishing elements is 400 mm – 600 mm.

For fixing wall panels, steel metal screws for fixing wood-based materials should be used, while for free-standing applications – screws generally used in furniture manufacturing.

Warning! Black drywall screws are not suitable for fixing wood-based panels.

While assembling the panels, persons performing the work should maintain appropriate safety regulations. Stop Fire fire-retardant chipboard panels should be applied on the basis of the construction project, taking into account the provisions and requirements of relevant standards and regulations. In the case of other applications, not included in this instruction, you should consult directly with the manufacturer of the panel.

Exemplary technical drawings:

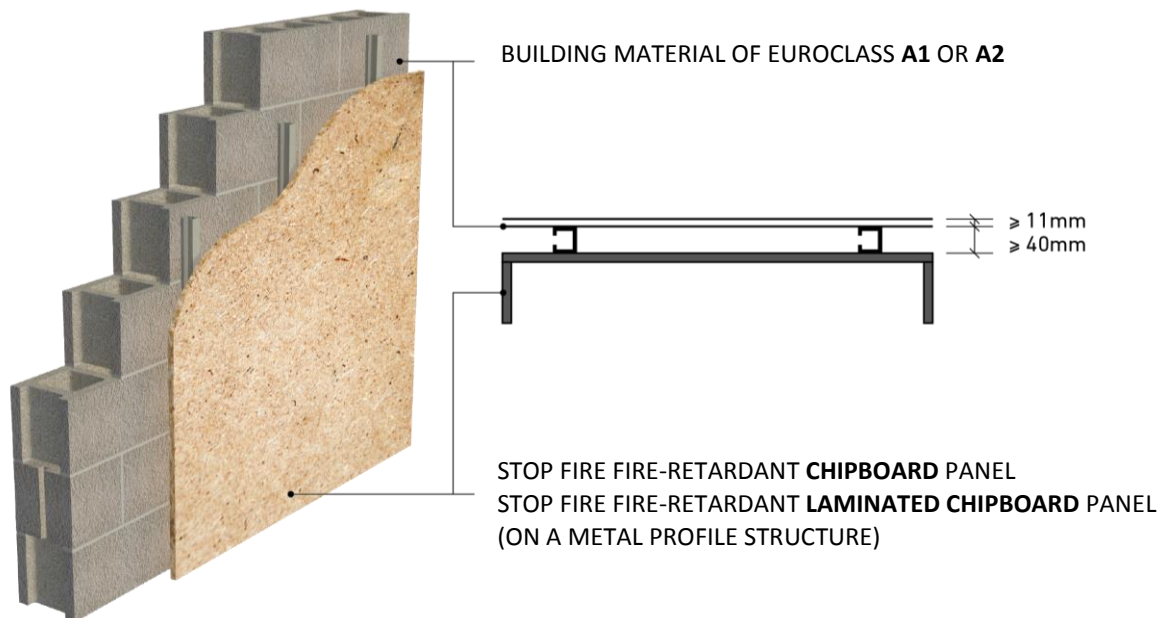
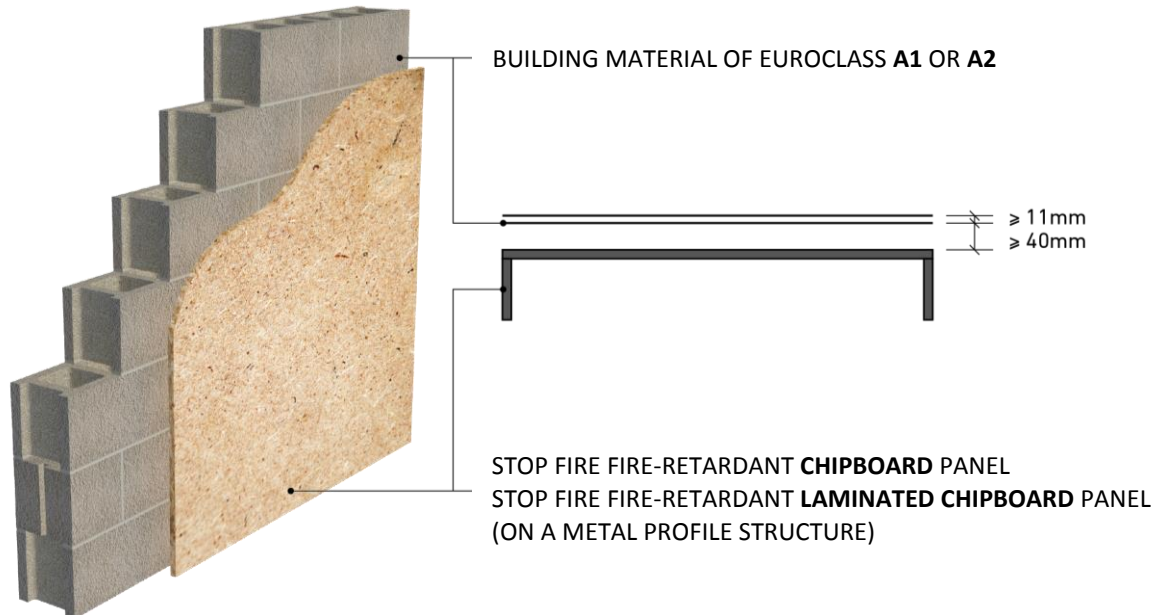

For Stop Fire fire-retardant chipboard panels and Stop Fire fire-retardant laminated chipboard panels, with a fire classification of B-s2,d0, apply the following conditions of use – according to the classification report:

- Free-standing application with a distance ≥ 40 mm from other flat building materials of European class A1 or A2-s1, d0 of thickness ≥ 11 mm and volumetric density $\geq 653 \text{ kg/m}^3$
- Mechanical fixing on a supporting structure from metal or wooden profiles with a distance ≥ 40 mm from other flat building materials of European class A1 or A2-s1, d0 of thickness ≥ 11 mm and volumetric density $\geq 653 \text{ kg/m}^3$
- Mechanical fixing to solid mineral surfaces of Euroclass A1 or A2 of density $\geq 37,5 \text{ kg/m}^3$ and thickness ≥ 25 mm
- Mechanical fixing to wooden or wood-based material basis of density $\geq 338 \text{ kg/m}^3$ and thickness ≥ 9 mm

Important! Using different construction materials, using different spaces, fixtures, using different joints/seams, different thickness or density, different coatings than those specified in the report, may adversely affect the product's reaction to fire enough, that the classification given in the report expires. Reaction to fire at different parameters requires a separate study.